

RANGE OF APLICATIONS:

Roofs at an angle of P > 7%



RAW MATERIALS:

- Steel quality: EN 10326
- Galvanized Steel: EN 10326
- Pre-coated Steel: EN 10169-1
- Polyurethane panel: UNE 41950
- Polyurethane injected without CFC's:
 - Compression resistance (10%): **2 kg/cm²**
 - Adhesion: **1,2 kg/cm²**
- Colours and qualities:
 - See the EUROPERFIL colour chart
 - Dark colours not recommended.
- See assembly and set up instructions.

PHISICAL CHARACTERISTICS

Thickness (mm.)	Weight (0,75/0,5) (Kg/m2)	Coefficient of Thermal Transmission K (Kcal/m2.h.°C)
30	10,5	0,60
40	10,9	0,45
50	11,3	0,36
60	11,7	0,30
70	12,1	0,26

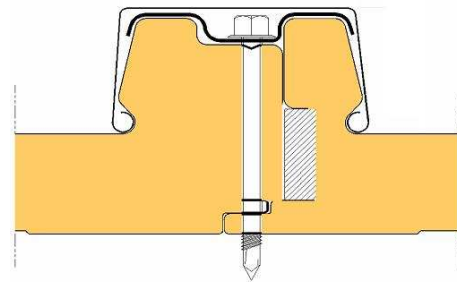

Weight in Kg/m² from the panel in 0,5 / 0,5 mm, including coverjoints.

Reaction to fire: M2, according to UNE 23727-90. EUROCLASS: **CS3D0**

According to the legislation EN 13501-1 la EUROCLASS: CS3D0 is equivalent to a product which is moderately combustible (C). Between 10 and 20 minutes until generalised ignition. With a lot of contribution to smoke (S3). And a product which does not produce drops of burning material.

CROSS SECTION

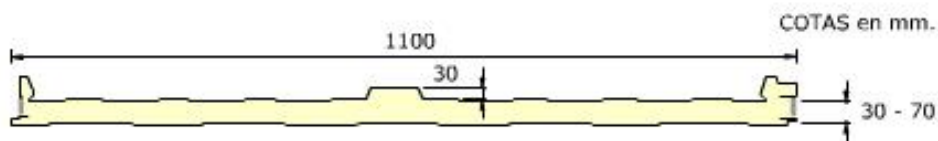

MANUFACTURING SPECIFICATIONS

PANEL	TOTAL WIDTH	USEFUL WIDTH	Polyurethane Foam		Outside face	Inside face		Lengths		
			Dens. Kg/m ³	Panel Thick.	Single Thickness	Min. Thick.	Max. Thick.	Min. Profil.	Min. Cut	Max. Profiled
DELFO	1118	1100	40	30-70	0,4	0,4	0,6	3000	100	14.400

HEADQUARTERS
 Avda. de la Granvia, 179
 Pol. Ind. Granvia Sur
 E - 08908 BARCELONA
 ☎ +34 93 261 63 33
 📠 +34 93 261 63 38
www.europerfil.es

CERVERA FACTORY
 Avda. Vall d'Aran, s/n.
 Pol. Ind. de Cervera
 E - 25200 CERVERA
 ☎ +34 973 53 20 26
 📠 +34 973 53 21 70

PANEL FACTORY
 Avda. Vall d'Aran, s/n.
 Pol. Ind. de Cervera
 E - 25200 CERVERA
 ☎ +34 973 53 20 26
 📠 +34 973 53 21 70

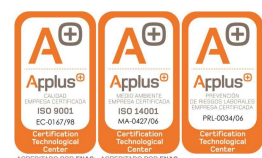

UPPER VIEW

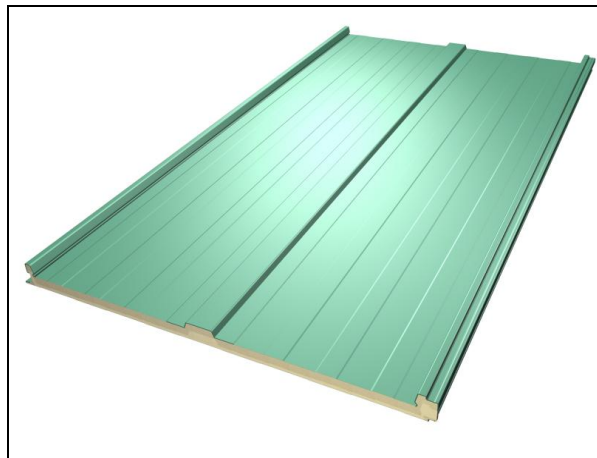

DETAIL

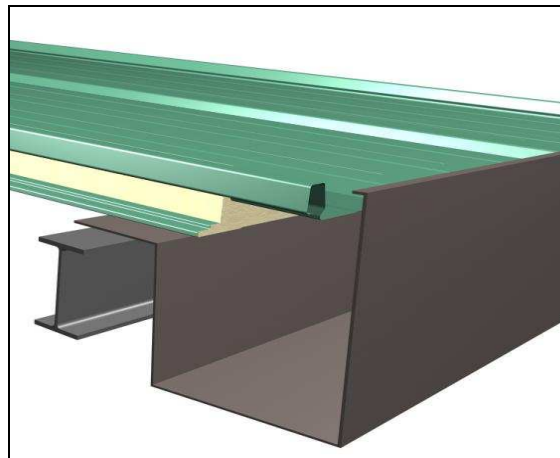

MECHANICAL CHARACTERISTICS

Decreasing loads

Panel Thickness (mm)	Admissible overload (daN/m ²)					
	TWO SUPPORTS					
	Span (m.)					
	2,50	2,75	3,00	3,25	3,50	3,75
30	93	75	-	-	-	-
40	120	100	82	-	-	-
50	163	135	116	98	84	-
60	192	170	143	120	105	90
70	218	195	166	141	121	100

Panel Thickness (mm)	Admissible overload (daN/m ²)							
	THREE SUPPORTS							
	Span (m.)							
	2,50	2,75	3,00	3,25	3,50	3,75	4,00	4,25
30	167	138	115	97	82	69	50	-
40	217	180	151	128	108	93	80	-
50	289	243	206	177	152	132	115	105
60	347	295	252	218	188	164	144	130
70	380	315	270	220	199	180	162	145